

Parabolic centrifuge PV25 - PV60



 Metal Chip Treatment Leader in the World
40 Years Experience & Qualified Supplier



✓ Advantages

- long service life
- highly wear-resistant execution
- vibration-proof set-up
- best possible degree of dryness
- fully automatic and continuous operation
- compact design
- very low maintenance costs
- very easy to maintain
- economic alternative to the lifting bottom centrifuge

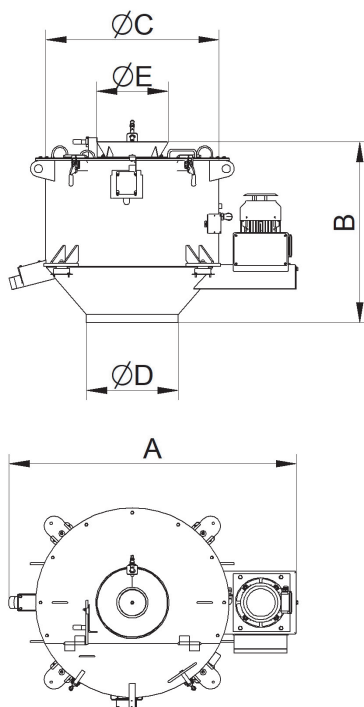

✓ Functional principle

The wet, free-flowing chips are fed into the infeed hopper of the centrifuge and fall into the drum. The centrifugal force presses the chips against the drum wall and they move upwards onto the slot sieve. At this point the coolant is separated from the chips.

The dried chips are carried over the edge of the drum and quit the centrifuge downwards into a chip cart or discharge conveyor.

The centrifuged liquid can be returned for further treatment into the machine-tool or can be pumped back into a coolant-cleaning system

Type	Throughput* [kg/h]			Dimensions [mm]					Capacity [kW]	Weight [kg]
	Steel/Stainless steel	Aluminium	Grey cast iron	A	B	Ø C	Ø D	Ø E		
PV25	250	80	375	960	530	590	450	250	0,75	120
PV40	700	230	1.000	1.440	910	950	450	350	2,20	400
PV50	1.500	500	2.000	1.740	1.120	1.170	550	440	3,50	650
PV60	2.500	850	3.500	2.050	1.350	1.350	600	500	3,50	850

* Throughput depending on kind of material and used coolant